



BST MACHINERY

ABOUT US

FOUNDED IN 2004, JINING BST MACHINERY CO., LTD. IS LOCATED IN JINING, SHANDONG. WE ARE A PROFESSIONAL ENTERPRISE ENGAGED IN THE MANUFACTURE AND SALE OF TRAILER SUSPENSIONS, TRAILER AXLES, TRAILER LANDING GEARS, SEMI-TRAILERS AND TRAILERS. WE CAN SUPPLY A WIDE RANGE OF PRODUCTS TO MEET THE EVER-CHANGING MARKET DEMANDS. CUSTOMIZED ORDERS ARE WELCOMED.

OUR MAIN MARKETS INCLUDE EUROPE, SOUTHEAST ASIA, THE MIDDLE EAST AND MAINLAND CHINA. OUR COMPANY INSISTS ON OUR BUSINESS SPIRIT OF "CUSTOMERS AS GODS, QUALITY AS TOP". WE ARE INCREASINGLY EXPANDING OUR INTERNATIONAL MARKET SHARE BASED ON QUALITY PRODUCTS, EXCELLENT SERVICES, REASONABLE PRICES AND TIMELY DELIVERY. PLEASE CONTACT US AT ANY TIME FOR MORE INFORMATION.

WE TREASURE EACH OPPORTUNITY TO COOPERATE WITH YOU. WE WILL USE OUR SINCERITY AND GOOD QUALITY TO WIN YOUR TRUST!!

Contact US

WEB: www.bst.pe www.bstchina.group
MAIL: INFO@bstchina.group
ADD: HIGH-TECH INDUSTRIAL ZOO, JINING CITY, SHANDONG PROVINCE, CHINA.

Katherine
+86 13953731580
Katherine@bstchina.group

Chris
+86 15263752014
Chris@bstchina.group

Alina
+86 17553718020
Alina@bstchina.group



**Jining BST Machinery
Co., Ltd.**

SINCE 2004

● 公司简介 About Us

With over 20 years experience in the industry, BST has developed its own professional, rigorous and high efficient production line, which is supported by a series of state-of-the-art manufacturing machines and processing lathes.

BST is capable of producing a wide range of high quality axles and suspensions that are suitable to different markets of the world. All BST products will be carefully tested by our QC team before moving into warehouses for export. All technical targets conform to or exceed the national standards.



● 公司简介 About Us



● 美式悬挂列 American Suspension Series

88 type Suspension Series

- One-Axle/ Two-Axle/ Three-Axle.
- Axle Type: 150*150/ ϕ 127/ 127*127
- Thickness: 6mm/ 8mm/ 10mm
- Height: 180/ 250/ _____
- Spring: 13*10/ 16*10/ _____

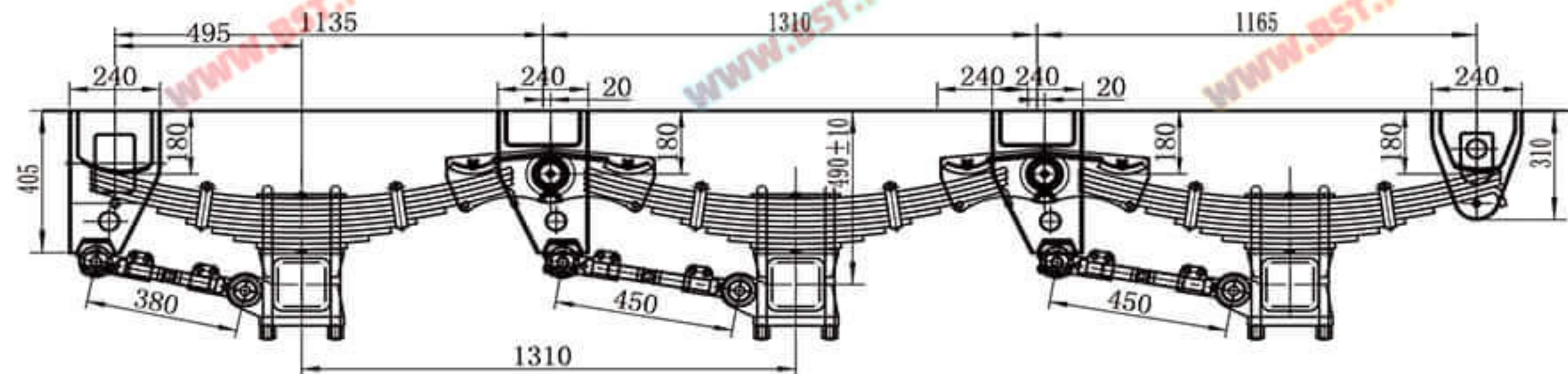
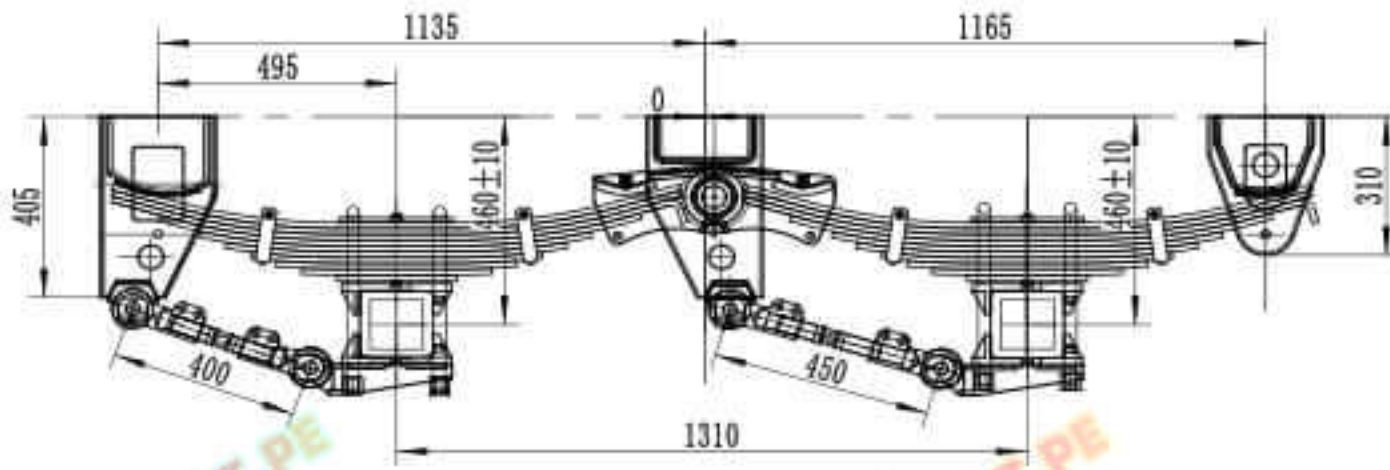

68 type Suspension Series

- One-Axle/ Two-Axle/ Three-Axle.
- Axle Type: 150*150/ ϕ 127/ 127*127
- Thickness: 4mm/ 6mm/ 8mm
- Height: 110/ 150/ _____
- Spring: 75*13*10/ 75*20/ _____
- TRA Series

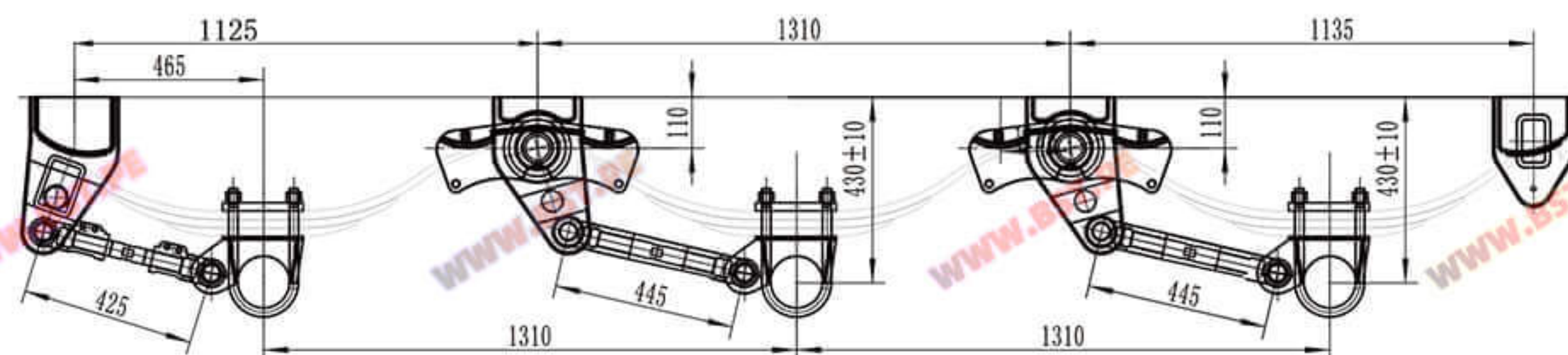
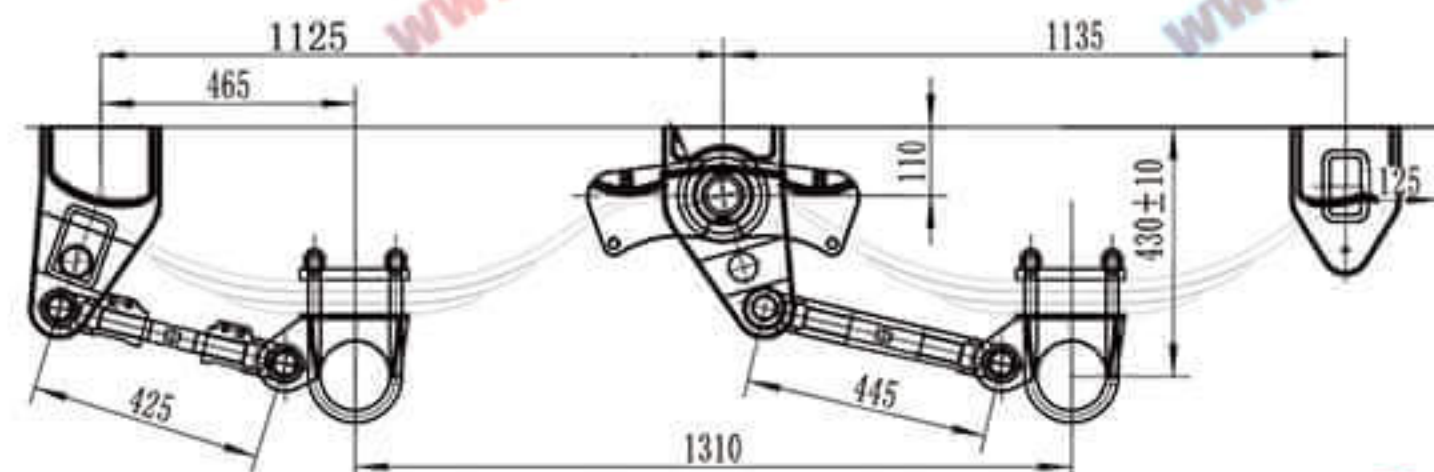

● 美式悬挂列 American Suspension Series

66 type Suspension Series

- One-Axle/ Two-Axle/ Three-Axle.
- Axle Type: ϕ 127
- Thickness: 6mm
- Height: 135/ _____
- Spring: 75*20/ 75*22/ _____

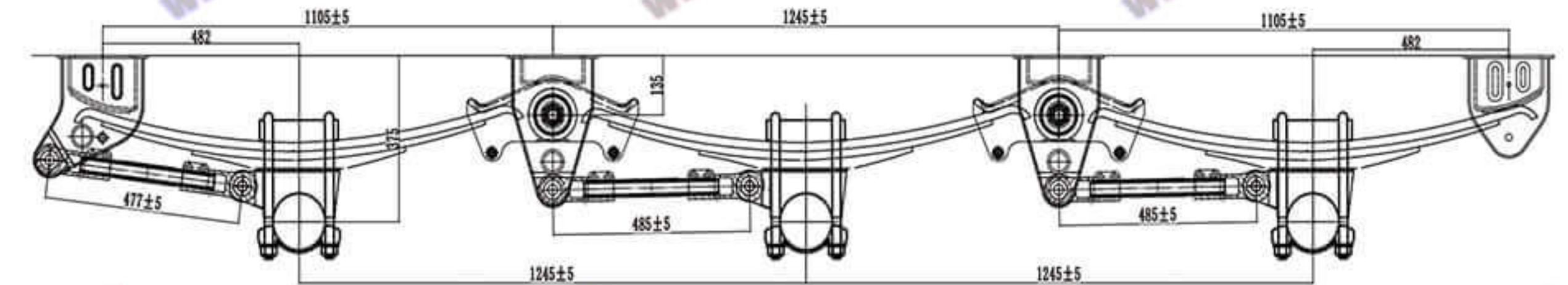
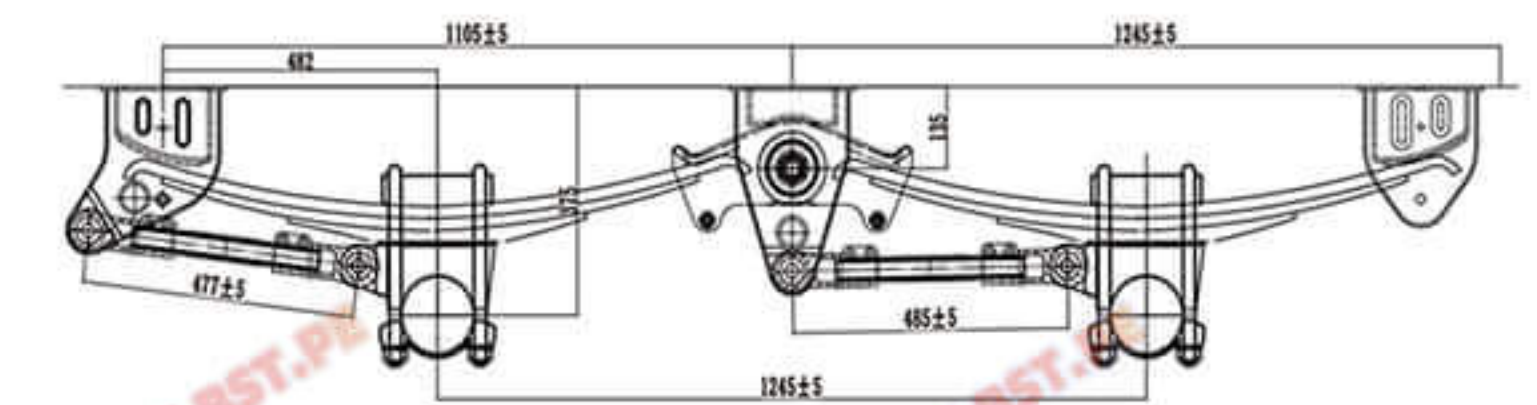
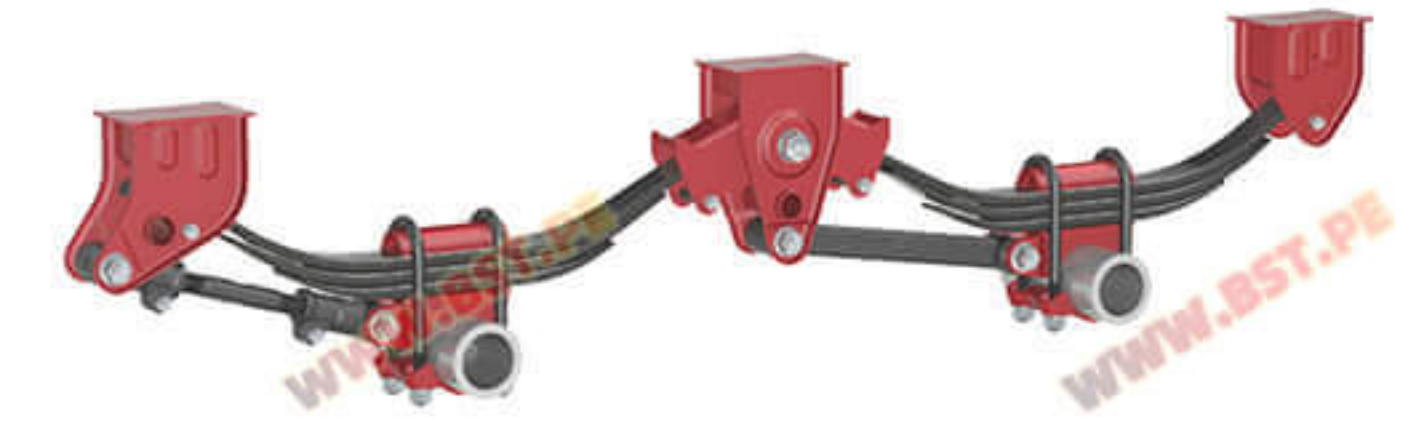

South Africa suspension

- Be manufactured for African road condition which needs tough and robust product
- better resistance against wear and tear.
- Very convenient to change accessories.
- Suitable for a wide range of models.
- High quality and low price.

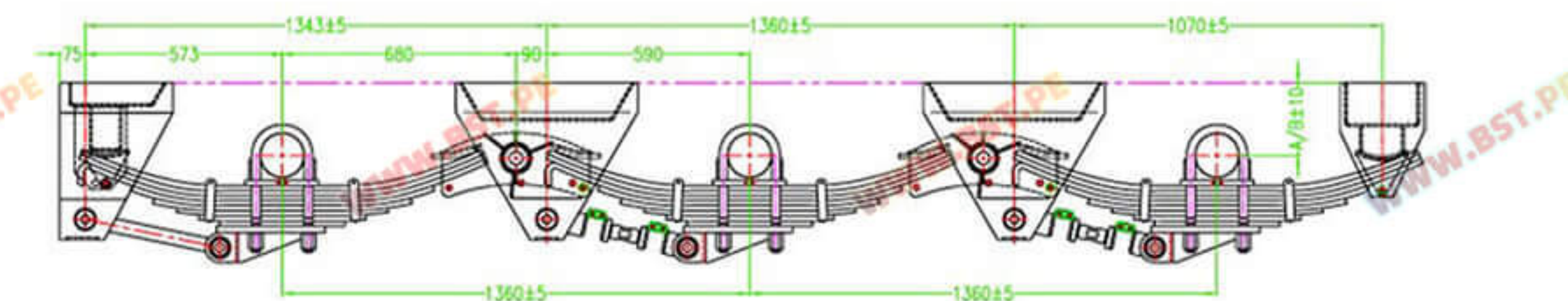
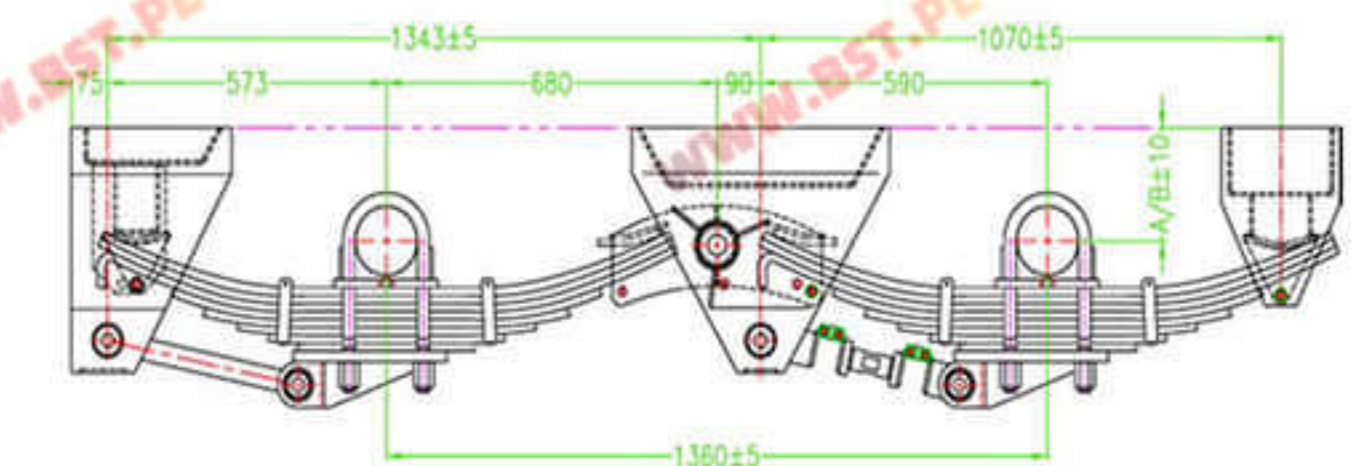

● 美式悬挂配件 American Suspension Parts

American Suspension Exploded view

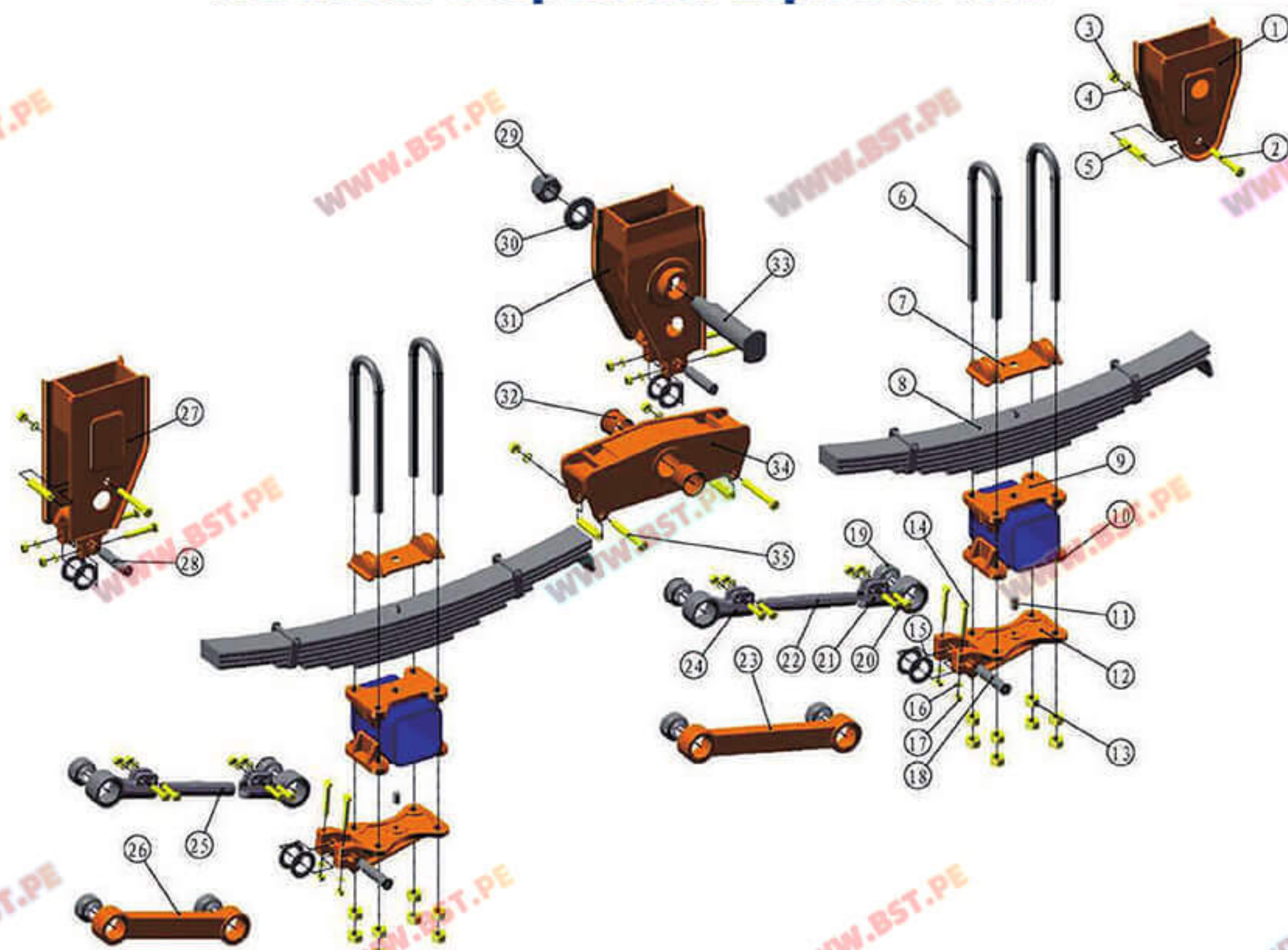

1.Rear hanger	19.Shock proof bush
2.Hexagon headed bolt M16x130	20.Hexagon headed bolt M14x60 (70)
3.Hexagon nut M16	21.Adjustable torque arm end R/H
4.Spring washer φ16	22.Adjustable torque arm screw II
5.Sleeve	23.Fixed torque arm assembly II
6.U-bolt	24.Adjustable torque arm end L/H
7.Cover plate spring	25.Adjustable torque arm screw I
8.Leaf spring assembly	26.Fixed torque arm assembly I
9.Upper axle seat	27.Front hanger
10.Lower axle seat	28.Torque arm pin
11.Dowel	29.Lock nut M42x3
12.Bracket	30.Washer φ42
13.Hexagon nut M24x2	31.Middle hanger
14.Hexagon headed bolt M14x85	32.Equalizer bush
15.Seal washer	33.Equalizer pin
16.Spring washer φ14	34.Equalizer
17.Hexagon nut M14	35.Hexagon headed bolt M16x140
18.Bracket coupling pin	

● Air Suspension Parts

Air Suspension Exploded view

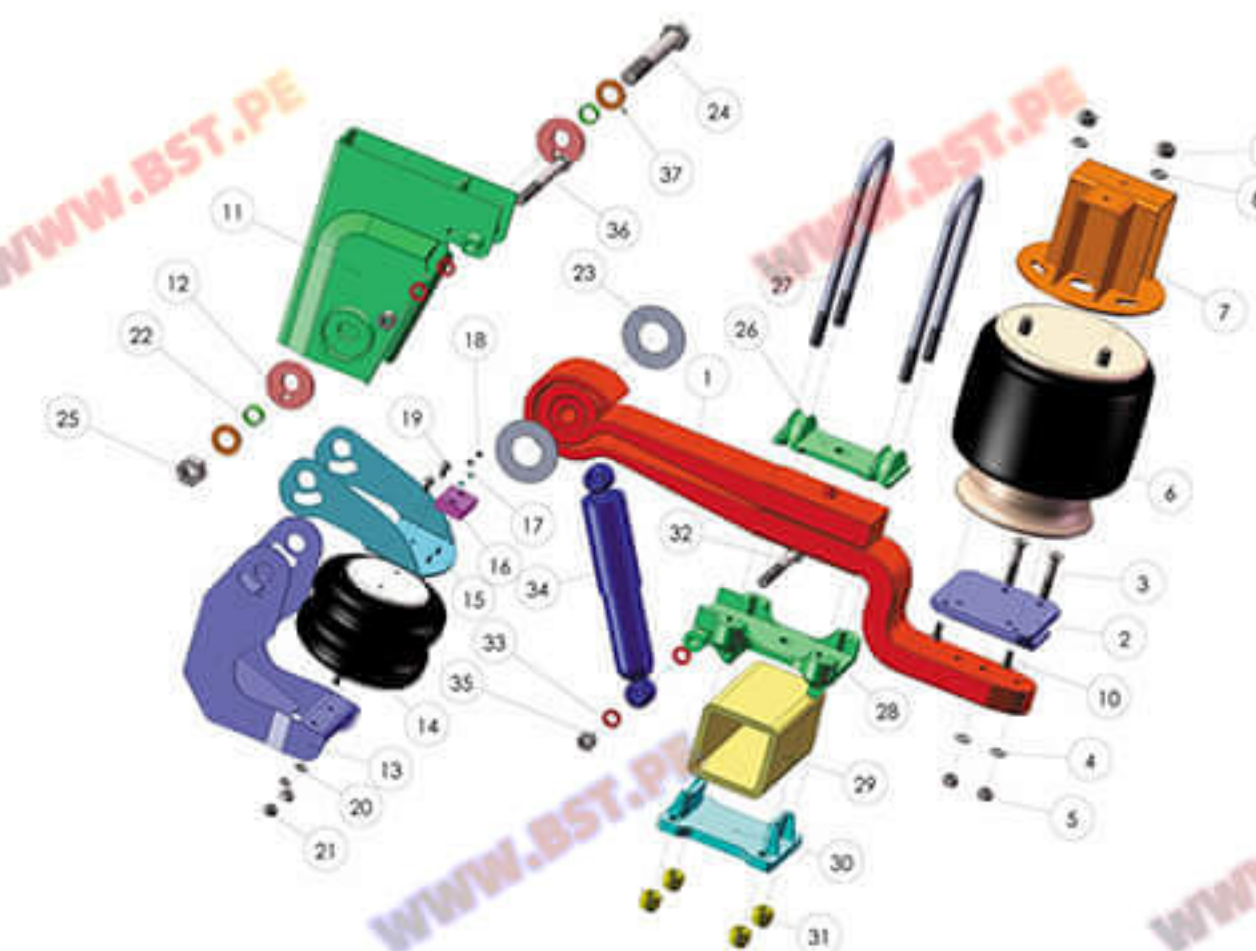

- | | |
|---|-------------------------------|
| 1. Oriented arm 导向臂 | 31. Self-locking nut 自锁螺母 M22 |
| 2. Plate components 垫板组件 | 32. Hex headed bolt 六角螺栓 M20 |
| 3. Hex countersunk head screw 内六角沉头螺钉 M16 | 33. Flat washer 平垫圈 20 |
| 4. Flat gasket 自锁螺母 M16 | 34. Shock absorber 减震器 |
| 5. Self-locking nut 凸轴轴衬套 | 35. Self-locking nut 自锁螺母 M20 |
| 6. Bearing air spring 空气弹簧 | 36. Hex headed bolt 六角螺栓 M20 |
| 7. Rear hanger 后支架 | 37. Flat washer 平垫圈 (二) |
| 8. Spring washer 弹簧垫圈 20 | |
| 9. Air spring fastening nut 空气弹簧固定螺母 | |
| 10. Air spring fastening bolt 空气弹簧固定螺栓 | |
| 11. Front hanger 前支架 | |
| 12. O Ring 偏心垫圈 | |
| 13. Wear-resistant plate 耐磨板 | |
| 14. Lifting air spring 空气弹簧 | |
| 15. Upper connection board 上连接板 | |
| 16. Rubbermat 胶垫 | |
| 17. Flat washer 平垫圈 6 | |
| 18. Self-locking nut 自锁螺母 M30 | |
| 19. Air spring fastening bolt 空气弹簧固定螺栓 | |
| 20. Spring washer 弹簧垫圈 14 | |
| 21. Hex nuts 六角螺母 | |
| 22. Axle sleeve 轴套 | |
| 23. Lower axle seat 下支板 | |
| 24. Hex headed bolt 六角螺栓 M30 | |
- The lifting part 提升部分**
If use the lifting M30 x 240 stud would instead of M30 x 220 螺栓
注: 带提升的用M30 x 240螺栓代替上表M30 x 220螺栓

<p>BST06-11</p> <p>Air Suspension</p>	<p>BST06-12</p> <p>Anti Air Suspension</p>	<p>BST06-13</p> <p>Air Suspension</p>	<p>BST06-14</p> <p>Anti Air Suspension</p>
<p>BST06-21</p> <p>Middle Lift Device</p>	<p>BST06-22</p> <p>Middle Lift Device</p>	<p>BST06-23</p> <p>Air spring</p>	<p>BST06-24</p> <p>Air spring Kit</p>
<p>BST06-31</p> <p>OEM=4630320200</p> <p>Hand brake valve</p>	<p>BST06-32</p> <p>ID=□60/□70</p> <p>load sensing valve</p>	<p>BST06-33</p> <p>OEM=4640060020</p> <p>Leveling Valve</p>	<p>BST06-34</p> <p>OEM=4630840000</p> <p>Lift Axle Control Valve</p>

● 美式悬挂配件 American Suspension Parts



● 美式悬挂配件 American Suspension Parts

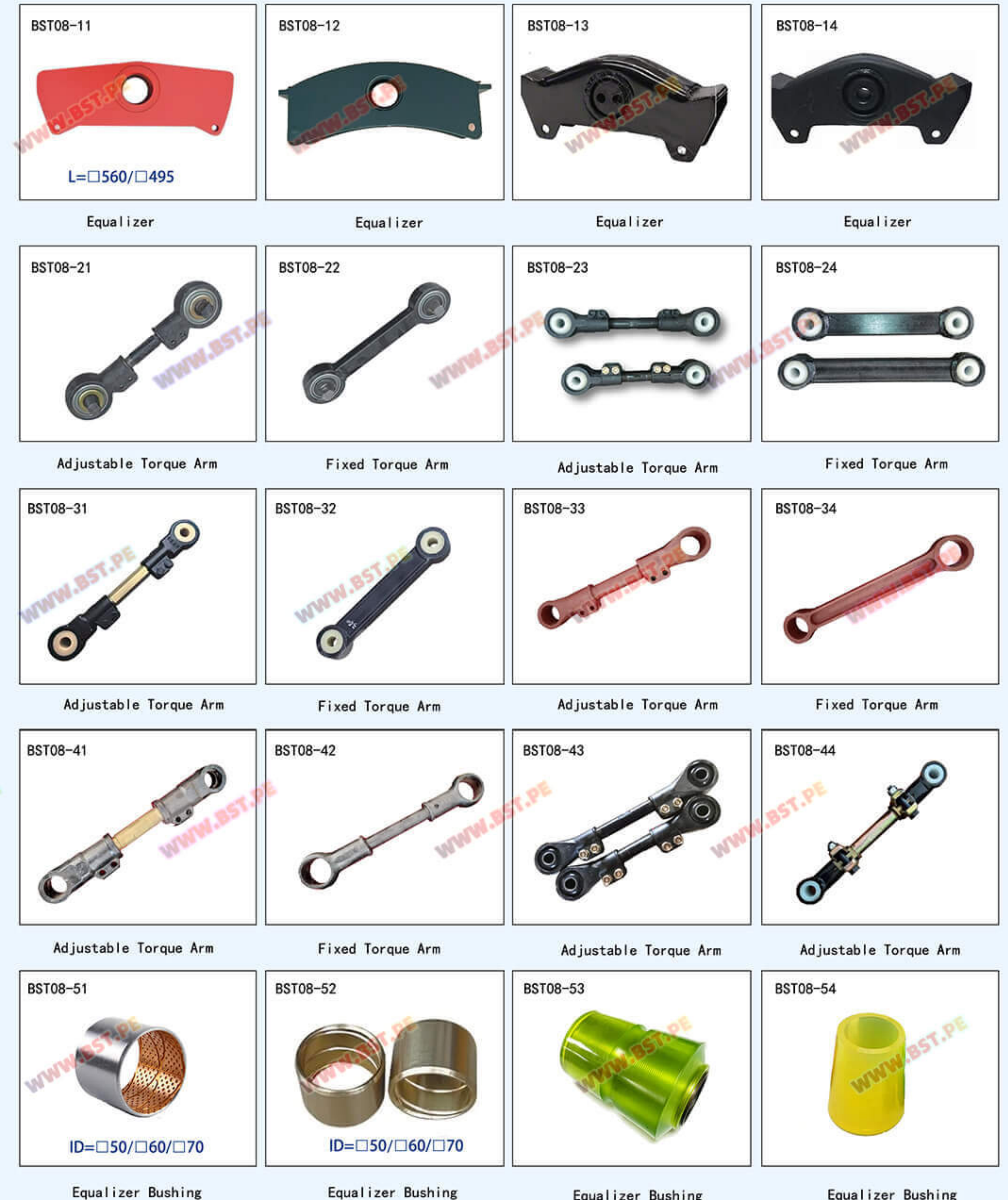

● 美式悬挂配件 American Suspension Parts

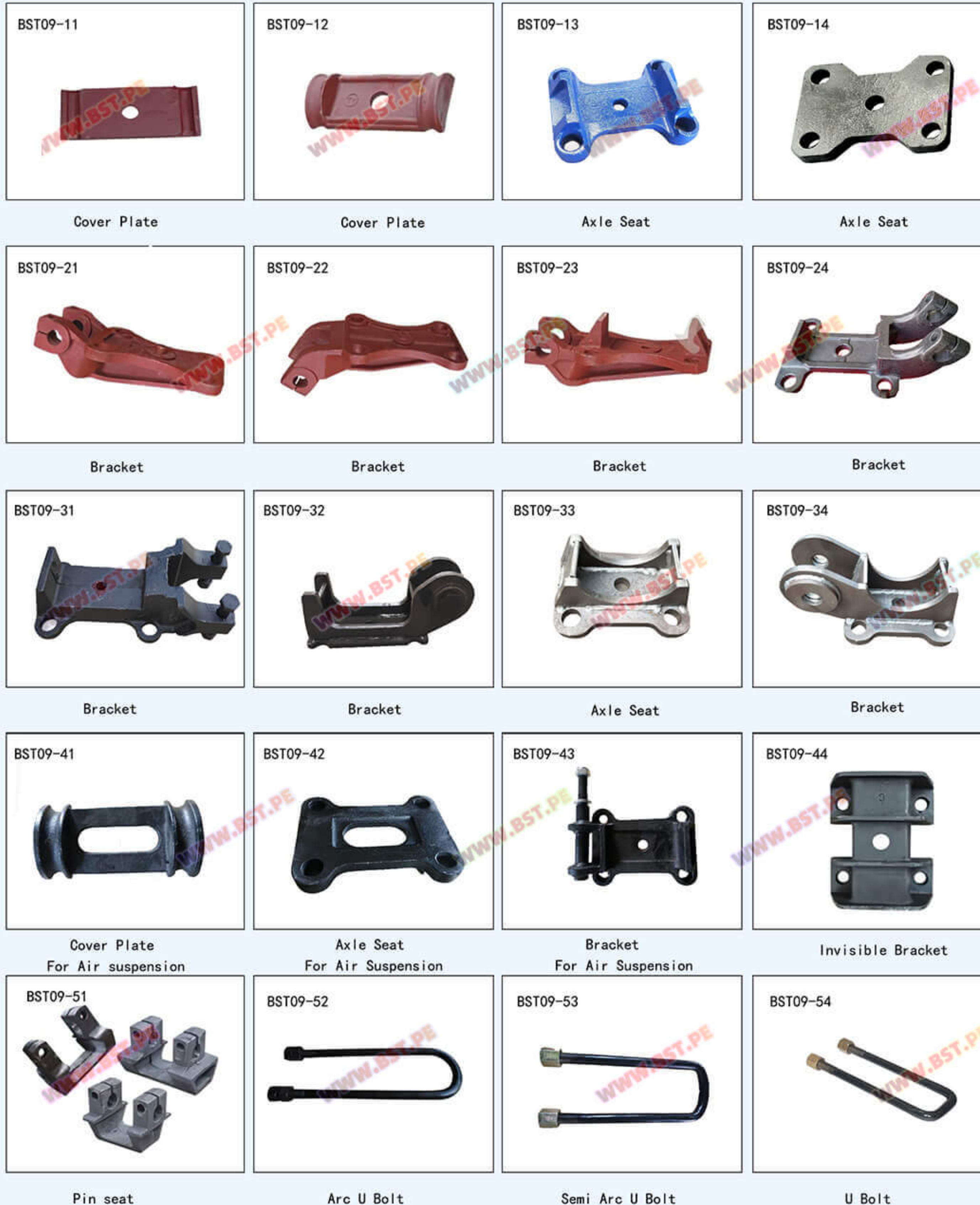

● 美式悬挂配件 American Suspension Parts



● 德式悬挂配件 Germany Suspension Parts

Germany Suspension Exploded view

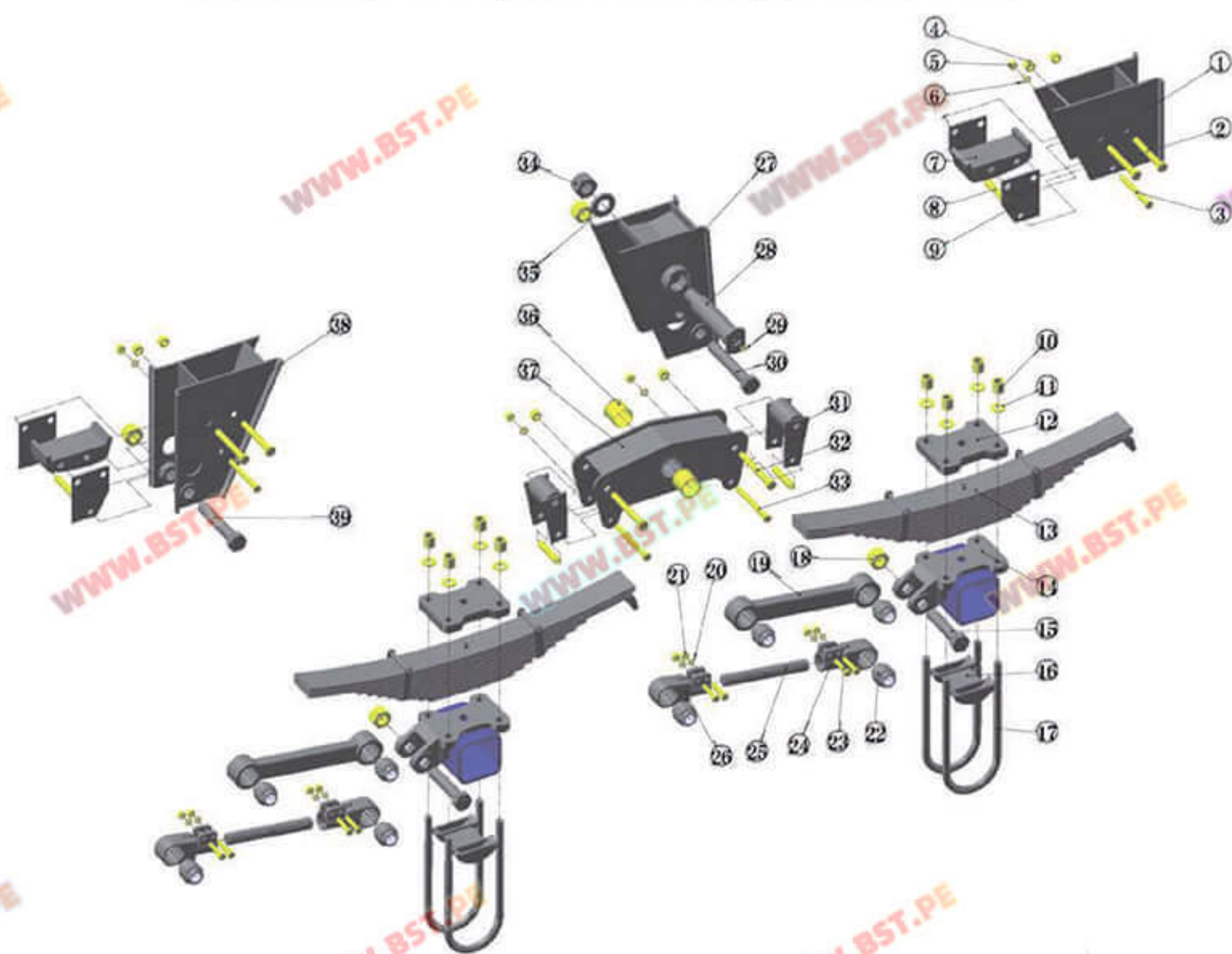

1.Rear hanger	21.Hexagon nut M14
2.Hexagon headed bolt M20x160	22.Shock proof bush
3.Hexagon headed bolt M16x160	23.Hexagon headed bolt M14x70
4.Lock nut M20	24.Adjustable torque arm end R/H
5.Hexagon nut M16	25.Adjustable torque arm screw
6.Spring washer φ16	26.Adjustable torque arm end L/H
7.Hanger spacer	27.Middle hanger
8.Sleeve	28.Equalizer pin
9.Reinforcing plate	29.Grease cup
10.Hexagon Nut M42x2	30.Hexagon headed bolt M36x225
11.Washer φ24	31.Reinforcing bracket for equalizer
12.Cover plate spring	32.Hexagon headed bolt M20x170
13.Leaf spring assembly	33.Hexagon headed bolt M16x170
14.Upper axle seat	34.Lock nut M42x3
15.Hexagon headed bolt M36x165	35.Washer φ42
16.Lower axle seat	36.Equalizer bush
17.U-bolt	37.Equalizer
18.Lock nut M36	38.Front hanger
19.Fixed torque arm assembly	39.Hexagon headed bolt M36x205
20.Spring washer φ14	

● 德式悬挂列 GERMAN SUSPENSION SERIES

BPW type Suspension Series

- One-Axle/ Two-Axle/ Three-Axle.
- Axle Type: 150*150
- Thickness: 8mm/ 10mm
- Height: 142/ _____
- Spring: 12*12/ 12*14/ _____

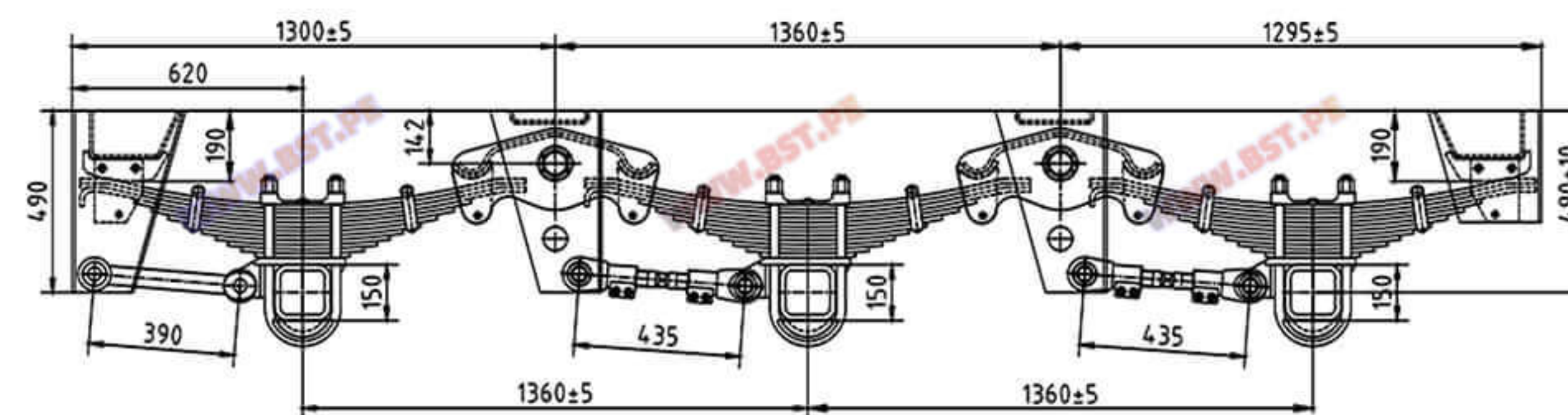

SAF type Suspension Series

- One-Axle/ Two-Axle/ Three-Axle.
- Axle Type: 150*150
- Thickness: 6mm/ 8mm
- Height: 155/ _____
- Spring: 12*12/ 12*14/ _____

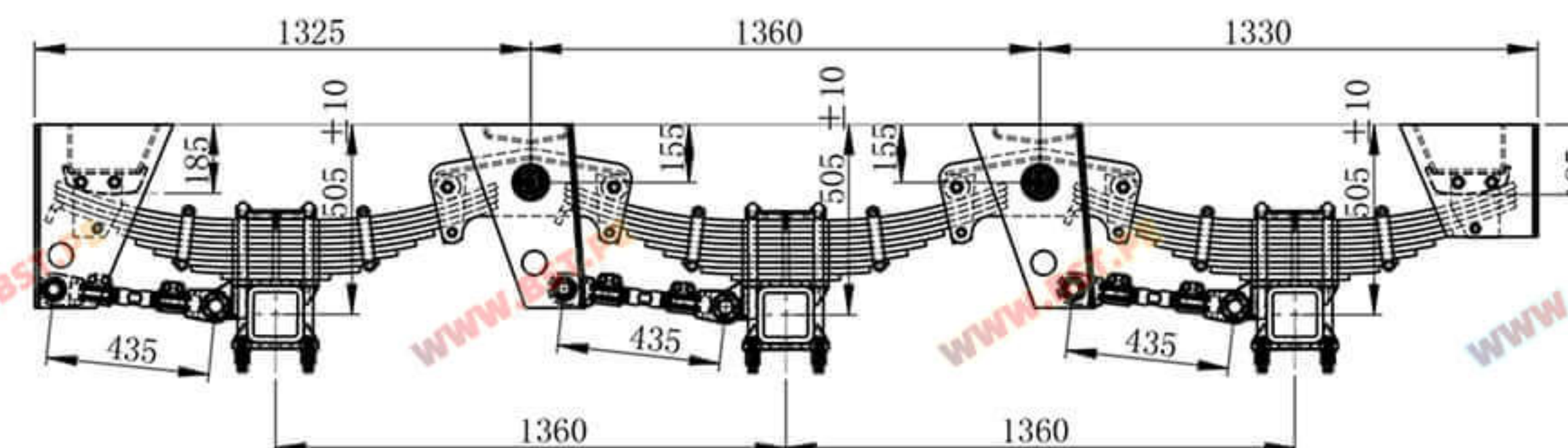

● 德式悬挂配件 Germany Suspension Parts



● 德式悬挂配件 Germany Suspension Parts



● 美式车桥系列 American Axle Series

American Axle Series

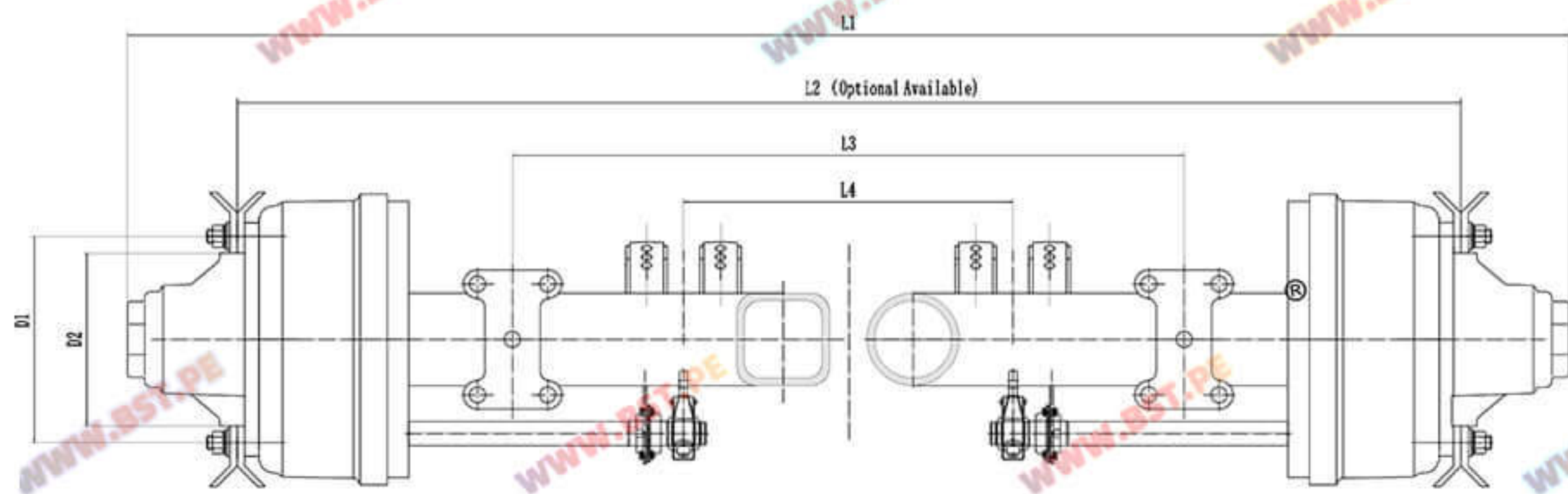

车轴型号 Axle Type	额定 负荷 Max Capacity (T)	轮距 SP (含 钢圈) Track (mm) L2	制动器规格 Brake Size (mm)	板簧座中心 距 Center Distance Of Spring Seat L3(mm)	轴管规格 (含厚 度)Axle Tube(mm)	气室间距 GM Center Distance of Brake Chamber L4 (mm)	轮毂连接Wheel Fixing			最大外 形长度 total Length L1 (mm)	推荐使用钢 圈Wheel Rim is recom- mended to use	车轴 重量 Weight (Kgs)	轴承 Bearing
							轮毂螺栓Studs	分布圆D1 (mm) P.C.D	中心孔直 径D2 (mm)Hole Diameter				
BST-AAYNDS110	11.5	1850	Φ311 × 190	≥950	Φ127 × 16	270	10-M22 × 1.5 ISO	225	176	2166	6.5-15 17.5 × 6.75	266	外轴承 518445/10 内轴承 518445/10
BST-AAFNDS130	13	1840	Φ420 × 180	≥930	150 × 150 × 12	390	10-M22 × 1.5 ISO	335	281	2185	7.5v-20	340	
BST-AAFNXS130	13	1840	Φ420 × 180	≥930	150 × 150 × 12	390	10-M22 × 1.5 ISO	285.75	221	2185	7.5v-20	340	外轴承 518445/10 内轴承 220149/10
BST-AAFNDS140	14	1840	Φ420 × 220	≥930	150 × 150 × 12	390	10-M22 × 1.5 ISO	335	281	2185	7.5v-20	358	
BST-AAFNDS150	15	1850	Φ420 × 180	≥940	150 × 150 × 14	394	10-M22 × 1.5 ISO	335	281	2205	8.0v-20	398	外轴承 518445/10 内轴承 220149/10
BST-AAFNDS160	16	1850	Φ420 × 220	≥940	150 × 150 × 14	354	10-M22 × 1.5 ISO	335	281	2205	8.0v-20	398	

- Type Optional: Inboard, Outboard, Low bed
- Tube Optional: □150, φ146, □127, φ127
- Wheel Stud Optional: 8/10

● 美式车桥分解图 American Axle Exploded View

American Axle Exploded view

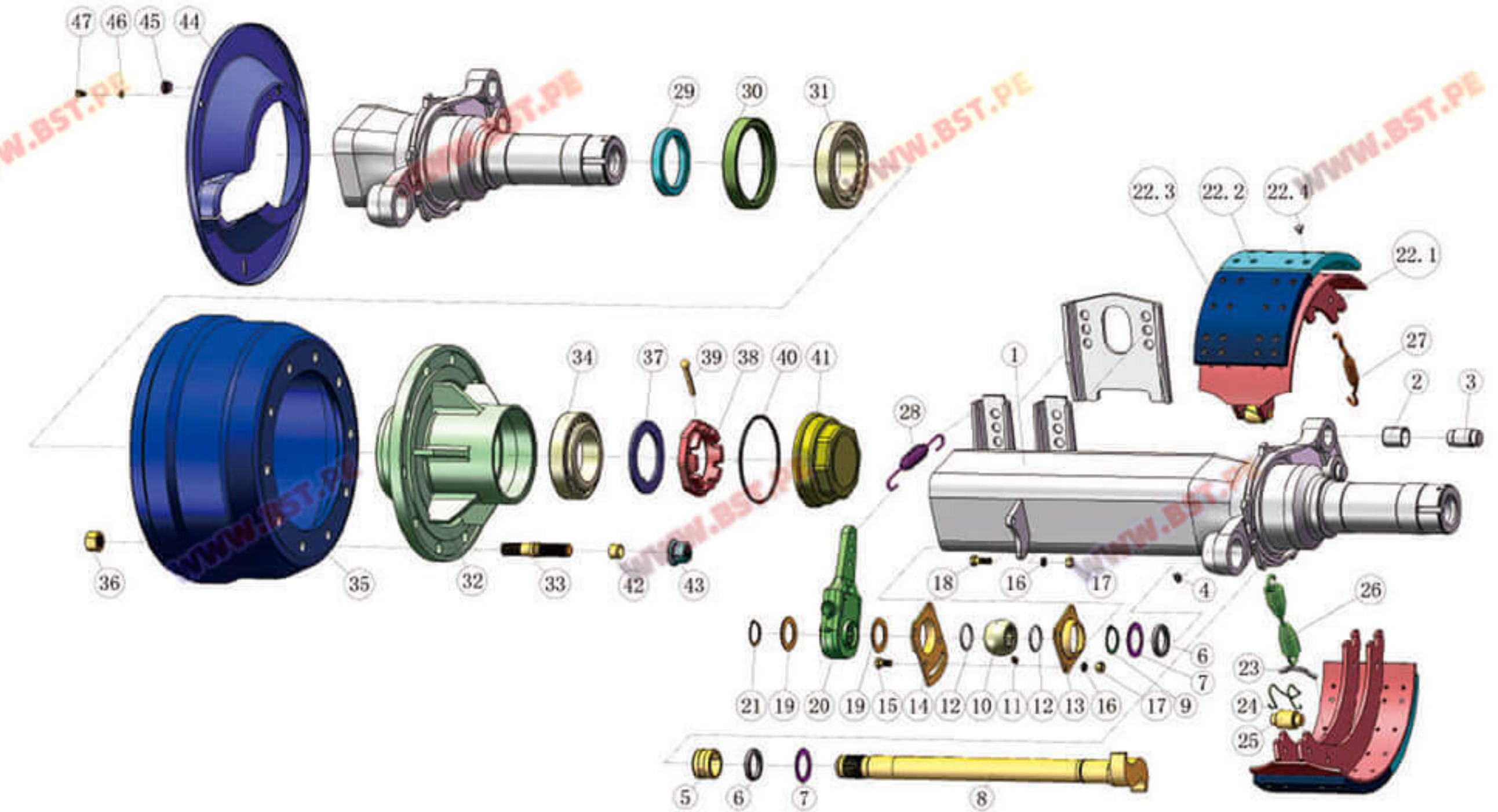

1.Axle beam assembly	18.M10x30 hexagon stud	31.Bearing
2.Fixed pin bush	19.Camshaft little washer	32.Hub
3.Anchor pin	20.Slack adjuster	33.Wheel stud
4.Grease nipple	21.Circlip for axle-A style	34.Bearing
5.Cam bush	22.Brake shoe assembly	35.Brake drum
6.Framework seal ring	22.1.Brake shoe bracket	36.Locknut
7.Camshaft big washer	22.2.Brake lining II	37.Lock washer
8.Camshaft	22.3.Brake lining I	38.Axle end locknut
9.Circlip for axle-A style	22.4.Tubular Rivet	39.Split pin
10.Cam bearing	23.Return spring pin	40.O ring
11.Grease nipple	24.Pin spring clip	41.Hub cap
12.O ring	25.Rotator pin	42.Wheel stud elastic sleeve
13.Bearing box I	26.Return spring	43.Wheel nut
14.Bearing box II	27.Retaining spring	44.Dust cover
15.M10x20 hexagon stud	28.Slack adjuster spring	45.Dust ring
16.Spring washer	29.Conical ring	46.Spring washer
17.M10 hexagon lock nut	30.Hub ring	47.Hexagon Stud

● 德式车桥系列 German Axle Series

GermanAxle Series

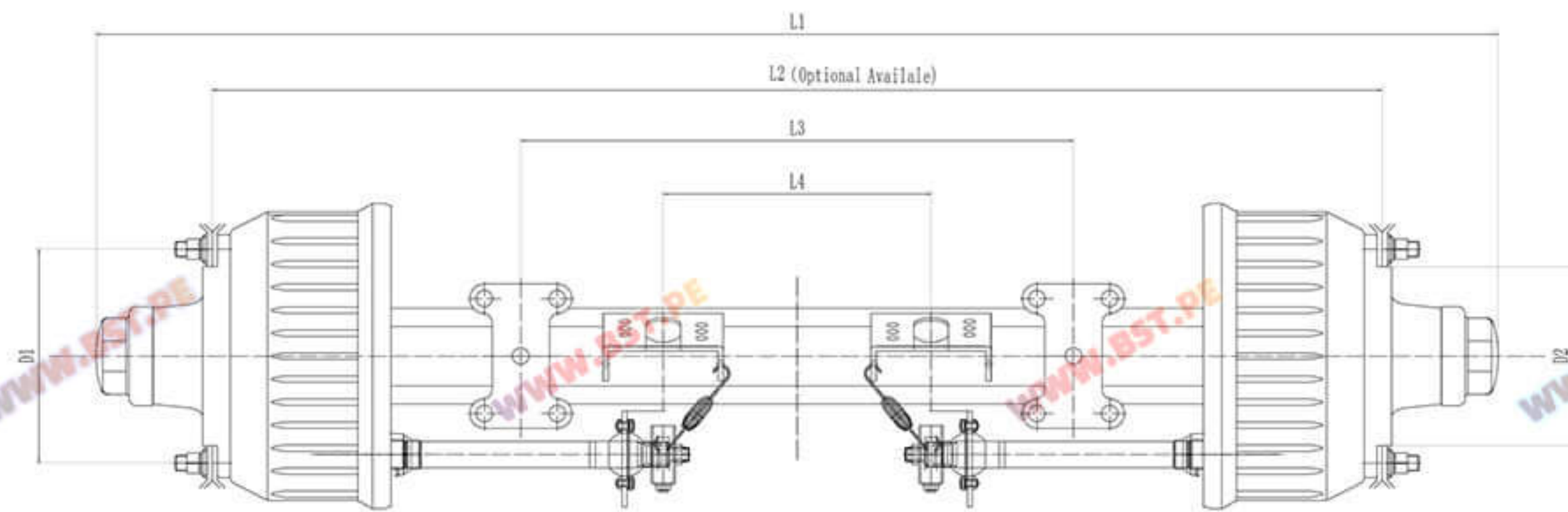

车轴型号 Axle Type	额定 负荷 Max Capacity (T)	轮距 SP (含 钢圈) Track (mm) L2	制动器规格 Brake Size (mm)	板簧座中心 距 Center Distance Of Spring Seat L3(mm)	轴管规格 (含厚 度) Axle Tube(mm)	气室间距 GM Center Distance of Brake Chamber L4 (mm)	轮毂钢连接 Wheel Fixing			推荐使用钢 圈 Wheel Rim is recom- mended to use	车轴 重量 Weight (Kgs)	轴承 Bearing	
							轮毂螺栓 Studs	分布圆D1 (mm) P.C.D	中心孔直 径D2 (mm) Hole Diameter				最大外 形长度 total Length L1 (mm)
BST-GAYNDS120	12	1840	Φ420 × 180	≥940	150 × 150 × 12	425	10-M22 × 1.5 ISO	335	281	2172	7.5v-20	380	外轴承33213 内轴承33118
BST-GAFNDS130	13	1840	Φ420 × 200	≥940	150 × 150 × 12	360	10-M22 × 1.5 ISO	335	281	2172	7.5v-20	381	
BST-GAFNXS140	14	1850	Φ420 × 200	≥950	150 × 150 × 14	370	10-M22 × 1.5 ISO	335	281	2222	8.00v-20	412	外轴33215 内轴32219
BST-GAFNDS160	16	1850	Φ420 × 200	≥950	150 × 150 × 16	360	10-M22 × 1.5 ISO	335	281	2293	8.50v-20	439	

● 德式车桥分解图 German Axle Exploded View

German Axle Exploded view

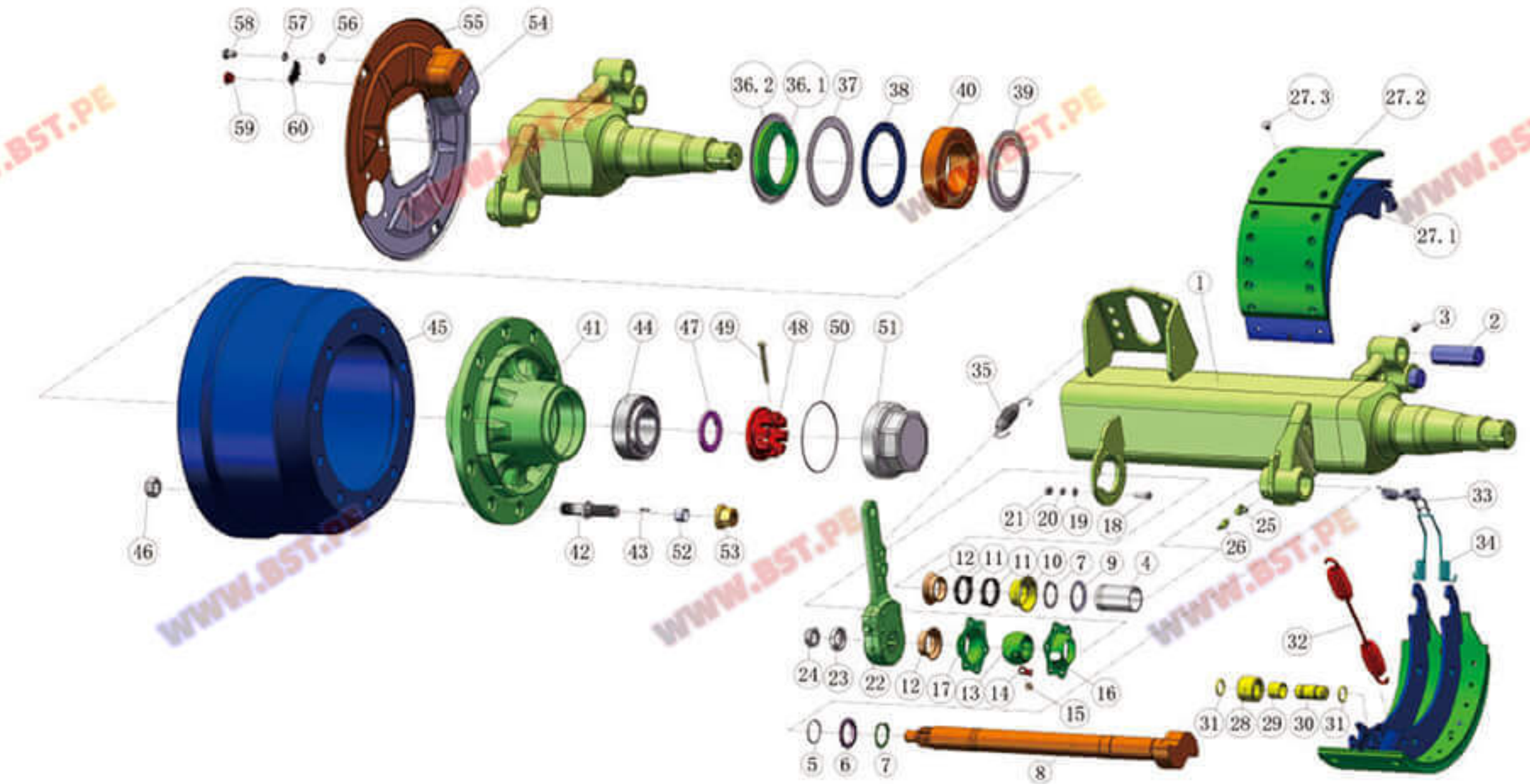

1.Axle beam assembly	23.Lock nut washer	40.Bearing
2.Anchor pin	24.Cam lock nut	41.Hub
3.Inner hexagon bolt	25.Cap I	42.Wheel stud
4.Cam bush	26.Gease nipple M8x1	43.Pin
5.O ring	27.Brake shoe assembly	44.Bearing
6.Thrust ring	27.1.Brake shoe bracket	45.Brake drum
7.Circlip	27.2.Brake lining	46.Lock nut
8.Camshaft	27.3.Tubular Rivet	47.Lock washer
9.Nylon ring	28.Brake roller	48.Axle end lock nut
10.Big dust wrapper	29.Bush	49.Split pin
11.Circlip	30.Camshaft roller	50.O ring
12.Middle dust wrapper	31.Ring	51.Hub cap
13.Cam bearing	32.Return spring	52.Wheel stud elastic sleeve
14.Cap II	33.Retaining spring I	53.Wheel nu
15.Grease nipple	34.Retaining spring II	54.Dust cover I
16.Bearing box II	35.Slack adjuster spring	55.Dust cover II
17.Bearing box I	36.Conical ring assembly	56.Washer
18.Bolt M8	36.1.Conical ring	57.Spring washer
19.Washer	36.2.Conical ring guard collar	58.Bolt M10
20.Spring washer	37.Big hub sealing	59.Dust ring
21.Nut M8	38.Small hub sealing	60.Plug
22.Slack adjuster	39.Bearing oil baffle	

● 车桥配件 Axle Parts

<p>BST19-11</p>  <p>Optional:</p> <ul style="list-style-type: none"> <input type="checkbox"/> Paint <input type="checkbox"/> Galvanized <input type="checkbox"/> Chromed/ 	<p>BST19-12</p>  <p>Optional:</p> <ul style="list-style-type: none"> <input type="checkbox"/> Paint <input type="checkbox"/> Galvanized <input type="checkbox"/> Chromed <input type="checkbox"/> 14T 	<p>BST19-13</p>  <p>Optional:</p> <ul style="list-style-type: none"> <input type="checkbox"/> 24T <input type="checkbox"/> 32T <input type="checkbox"/> Paint <input type="checkbox"/> Galvanized <input type="checkbox"/> Chromed
---	--	--

Fuwa Axle Cap

BPW Axle Cap

Bogie Cap

<p>BST19-21</p> 	<p>BST19-22</p> 	<p>BST19-23</p> 	<p>BST19-24</p> 
---	---	---	---

FUWA Axle Nut

BPW Axle Nut

ECO Axle Nut

Bogie Axle Nut

<p>BST19-31</p> 	<p>BST19-32</p> 	<p>BST19-33</p> 	<p>BST19-34</p> 
---	---	---	---

Hub

Drum

BPW Hub

BPW Drum

<p>BST19-41</p> 	<p>BST19-42</p> 	<p>BST19-43</p> 	<p>BST19-44</p> 
---	---	---	---

Break Pad

Break Shoe

Break Assembly

Rivet

<p>BST19-51</p> 	<p>BST19-52</p> 	<p>BST19-53</p> 	<p>BST19-54</p> 
---	---	---	---

13T Wheel Bolt

16T Wheel Bolt

BPW Wheel Bolt Old Model

BPW Wheel Bolt New Model

● 车桥配件 Axle Parts

<p>BST20-11</p> 	<p>BST20-12</p> 	<p>BST20-13</p> 	<p>BST20-14</p> 
---	---	---	---

Fuwa Oil Seal

BPW Oil Seal

York Repair Kit

ECO Repair Kit

<p>BST20-21</p> 	<p>BST20-22</p> 	<p>BST20-23</p> 	<p>BST20-24</p> 
---	---	---	---

Fuwa Camshaft Repair Kit

BPW Camshaft Repair Kit

Fuwa Break Repair Kit

BPW Break Repair Kit

<p>BST20-31</p> 	<p>BST20-32</p> 	<p>BST20-33</p> 	<p>BST20-34</p> 
---	---	---	---

Slack Adjuster Sping

Fuwa Dust Cover

BPW Dust Cover

Bearing

<p>BST20-41</p> 	<p>BST20-42</p> 	<p>BST20-43</p> 	<p>BST20-44</p> 
---	---	---	---

Slack Adjuster

Slack Adjuster

Slack Adjuster

Automatic Adjuster

<p>BST20-51</p> 	<p>BST20-52</p> 	<p>BST20-53</p> 	<p>BST20-54</p> 
---	---	---	---

Fuwa Camshaft

BPW Camshaft

Tiro

Wheel

● 板簧、导向臂系列 Spring&Guide Arm Series



● 转锁及角件 Twist Lock Series



● 牵引销系列 King Pin ttSeries

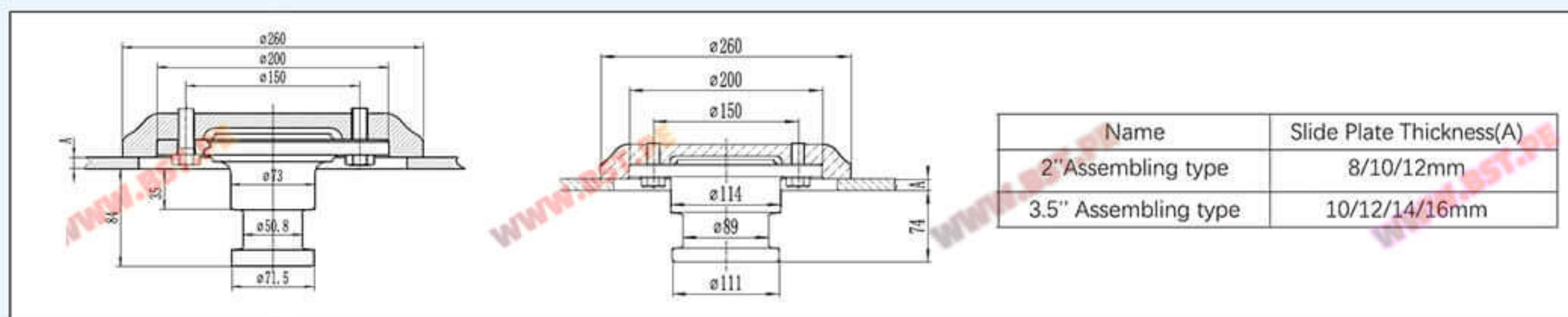

50# Welded King Pin

50# Bolted King Pin

50# Bolted King Pin

50# Bolted King Pin



90# Welded King Pin



90# Bolted King Pin



90# Bolted King Pin



King Pin Bolt



90# King Pin



50# Welded King Pin



King Pin Lock



King Pin Adapter



Traction Rod



Traction Device



Traction Device



Traction Device

● 支腿系列 landing Gear Series



Landing Gear Box



Shake Hand And Link Rod



Landing Gear Feet



Landing Gear Bracket

● 鞍座系列 Fifth Wheel Series



Welded Fifth Wheel



Strengthen Fifth Wheel



Cast Fifth Wheel



Movable Fifth Wheel



Turn Table



Base Plate



Fifth Wheel Repair Kit



Fifth Wheel Pedestal

● 气路配件 Air accessories

 T30 Break Chamber	 T30/30 Break Chamber	 Break Hose	 Pipe Connector
 Air Brake Coupling	 PU Pipe 12mm	 PU Pipe 4mm	 Coil Air Hose
 Pipe Connector	 Pipe Threaded Connector	 Hose Clamp	 Hose Clamp
 Pipe Threaded Joint	 Pipe Threaded Connector	 Air Tank	 Aluminium Air Tank
 Relay Valve	 Synchronous Relay Valve	 Three Bridge Valve	 ABS Pump

● 电路配件 Electrical Accessories

 Semi Trailer Wire	 ABS Ring	 ABS Hanger	 ABS Sensor
 5 Pin Copper Wire	 7 Pin Wire	 7 Pin Socket Adapte	 7 Pin Plug Socket
 Lamp	 Taillight	 CIMC Tail Light	 CIMC Tail Light
 Reflector	 Reflector	 Lamp	 Lamp
 Side Light	 Lamp	 Tail Light	 License Plate Light